



# Spare Parts Catalog

4 WG 200(555/5)

Material number: 4644.024.228

ZF Friedrichshafen AG

Hauptverwaltung

80038 Friedrichshafen

Deutschland

Telefon: +49 7541 77-0

Telefax: +49 7541 77-908000

[www.zf.com](http://www.zf.com)

zuständiges Werk:

Passau

# Notes relating to the spare parts catalog

## Setup of the spare parts catalog

- Cover sheet
- Technical Cover (only in SDM print)
- Overview of figures
- Figure
- Associated parts list
- Next figure
- Associated parts list
- ...

## Figure and parts list

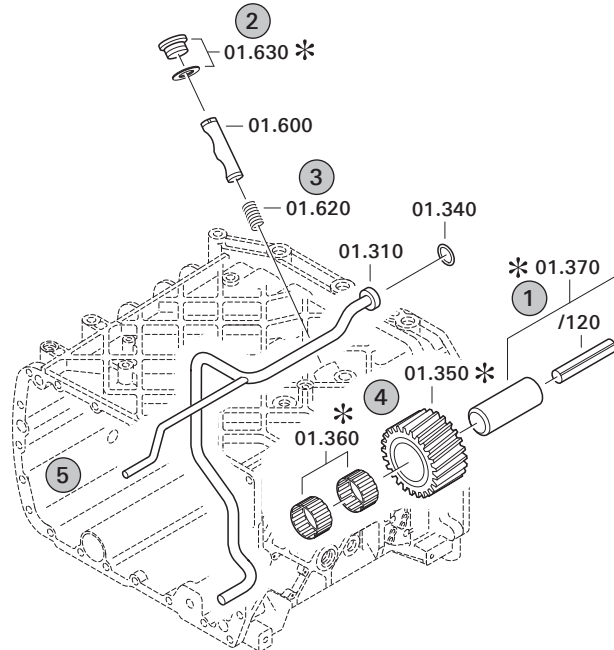

## Overview of figures

Bildtafel Figure	Sachnummer Product number	Benennung (Description)	Technische Info Technical info	Description (Benennung)	Menge Quantity	Einheit Unit
068.08.17	1316.170.001	AUSLEGER	WL	SHIFT TURRET	1	Stk
068.08.06	1316.170.031	DECKEL	WL*H-H*VM	COVER	1	Stk
068.08.14	1316.170.808	DECKEL	WL*AUSL+GEH*H-H*HF160N	COVER	1	Stk
08	1316.170.441	ANSCHLUSSTEILE	WL*NG-VORB*RG-SCHL*168N*BAJONETT	CONNECTING PARTS	1	Stk

The "gap" indicates that there is no separate graphics panel (poster) for this assembly  
The parts of this assembly are shown with the same mid-section number on the figure

### 1 Positions and subpositions

Pos.	Sachnummer Product number	Benennung (Description)	Technische Info Technical info	Description (Benennung)	Menge Quantity	Einheit Unit
0370	1315.201.054	RUECKLAUFBOLZEN	KPL.16S151*SG*L= 79	REV.IDLER SHAFT	1	Stk
/0120	0631.329.293	SPANNSTIFT		SLOT. PIN	1	Stk

Positions marked with "/" are the individual items of a completion  
For example: Position 0370 contains a centering pin with the position /0120

### 2 Combinations with standardized parts

Pos.	Sachnummer Product number	Benennung (Description)	Technische Info Technical info	Description (Benennung)	Menge Quantity	Einheit Unit
0630		VERSCHL.SCHR.		SCREW PLUG	1	Stk
	0636.302.067	VERSCHL.SCHR.		SCREW PLUG	1	Stk
	0634.801.249	DICHTRING	A 26 X 31	SEALING RING	1	Stk

The parts list shows the components included in the combination of standardized parts

### 3 Depiction of position/item number on the figure and in the parts list

01.620 - on the figure      01 relates to the assembly in which the position is included. Due to program-related reasons, it is shown on the figure.

0620 - in the parts list

Pos.	Sachnummer Product number	Benennung (Description)	Technische Info Technical info	Description (Benennung)	Menge Quantity	Einheit Unit
0620	0732.040.736	DRUCKFEDER		COMPRESSION SPRING	1	Stk

### 4 \*-Positions

Positions marked with an \* are optional i.e. inclusion in the parts list is not mandatory.  
The following note is shown on the figure

je nach Stücklistenausführung  
depending on spec. number  
\*  
suivant la nomenclature  
secondo la distinta base

### 5 Parts, dotted display

Parts with dotted display on the figure are only used for orientation of other parts



Pos.	Information	Amendment number
	KUNDE:LIN-YI	
	IDENT-NO.: WITHOUT	
	PROJEKT-NR.:35211	
	VEHICLE DATA:	
	WHEEL LOADER ZL 50	
	VEHICLE WEIGHT: EMPTY .....T	
	VEHICLE WEIGHT: LOADED 17,50T	
	MOTOR: SHANGHAI DIESEL 6121	
	MOTORLEISTUNG: P=160 KW BEI N=2200 UPM	
	ENGINE PERFORM.ACC.TO TRACTIVE EFFORT CALCUL.	
	DREHMOMENT: T= 880 NM BEI N=1320 UPM	
	TYRES: 23.5-25	
	R.DYN. 0,760 M	
	ACHSUEBERSETZUNG:I A-GES.= 23,258	
	V-MAX: 38,00KM	
	FAHRLEIST.BERECHNUNG: 4644 711 620	
	PRODUCT DESCRIPTION:	
	TYP: 4WG-200(555)	
	FORDING ABILITY: NO	
	RATIOS TOTAL:	
	FORWARD:	
	1.G=4,278 2.G=2,368 3.G=1,126 4.G=0,648	
	REVERSE:	
	1.G=4,278 2.G=2,368 3.G=1,126	
	HIGH GEARING: INPUT	
	INPUT:	
	DIRECT FLANGE ATTACHMENT	
	SAE-ANSCHLUSS: 2 LANG	
	OUTPUT:	
	FLANGE: LEFT MECH.7C	
	FLANGE: RIGHT MECH.7C	
	POWER TAKE-OFF(P.T.O):	



Pos.	Information	Amendment number
	COAX.ENGINE DRIV:FLANGE SAE-C 2/4 HOLE	
	COAX.ENGINE DRIV:SPL.SAE-C/12/24 DP/14T	
	LATERAL/ENGINE DRIVEN:FL.SAE C/2/4-HOLE	
	LATERAL/ENGINE DRIVEN:SP.SAE C/12/24 DP 14T	
	REVERSING GEAR DRIVEN: N0	
	TURB.DRIVEN NO	
	CONTR.MECH.: NO	
	GEAR SELECTION:	
	CODE: G	
	ELECTRICAL	
	MOUNTING POSIT.: LATERAL AT THE GEARBOX ABOVE	
	VOLTAGE: 24 VOLT	
	OPERATING PRES.: 16+2 BAR	
	PRESSURE CONTROLL:2,5/5-13 BAR NO.24	
	CONNENCTION WIRING:CANNON SCREW CONNECTION	
	OIL INLET TO CONTROL:GEAR BOX	
	REPLENISHING OIL:WITH	
	CONVERTER LOCK-UP CONTROL: WITHOUT	
	DOUBLE PRESSURE CONTROL VALVE: WITH/M4	
	PRESS.CUT-OFF: YES	
	SETTING SPECIFICATION: 4644 700 681 IN 467	
	WARNING SWITCH F. OIL PRESSURE: WITHOUT	
	WARNING SWITCH F.OIL TEMPERATURE:WIHOUT	
	GEAR SELECTOR:	
	TYP: DW 3 MIT EST-17T	
	STEER.COL.: LEFT	
	REVERS.UP:TO SEED DEPEND.	
	WIRING: WITH	
	INDUCTIVE SENSOR,TURBINE SIDE: WITH	
	INDUCTIVE SENSOR: WITHOUT	
	PERKING BRAKE: DRUM-BRAKE	
	SPEEDOMETER: WITHOUT	